

Map Series:  
Prime Data Vector

ITM Centre Point Co-ordinate:  
X,Y = 545125.63,728672.74

Tailte Éireann Licence No.  
CYAL50510216

Copyright:  
© Tailte Éireann, 2026

The planned 220kV grid route transverse through the following Townlands listed below

1. Rathmorrissey
2. Pollangroagh
3. Moanbaun
4. Castletambert
5. Knocknacreeva
6. Caranduff
7. Caherbriskaun
8. Lisheenkyle East
9. Barrettspark
10. Cashla

MATCHLINE REF TO 300101269-DR-111



Head Office  
Besenrigh,  
Abbeydorney,  
Tralee, Co. Kerry  
Ireland  
Tel: 00353 66 7135710

Regional Office  
Basepoint Business Centre  
Stroudley Road, Basingstoke,  
Hampshire,  
RG24 8UP, UK  
Tel: 00 44 1256406664

**PROJECT**

**Cashla Peaker Plant 220kV  
Grid Connection & Substation**

**CLIENT**

**CONSULTANTS**

**NOTES: -**

- This drawing is to be used only for the purpose of the planning application and is subject to detailed design.
- Position of underground cable and location of joint bays, links boxes and comms chambers may vary depending on site conditions.
- Position of link boxes and comms chambers is to be agreed onsite with EirGrid/ESB.
- Other services may be encountered on the route.

**LEGEND: -**

- Proposed 220 kV UGC Grid Connection Route (8.1km)
- Planning Boundary
- Site Ownership Boundary
- Existing ESB OHL HV Network
- Existing ESB OHL LV/MV Networks
- Irish Water Infrastructure
- Existing Eir Network OHL
- Existing Irish Gas Networks
- Wayleave Boundary
- Existing Levels + 31.105m

**ISSUE/REVISION**

NO	DATE	DESCRIPTION
P3	13.03.26	Issued for Planning
P2	03.02.26	Issued for Information
N2	05.11.25	Issued for Information
P1	05.09.25	Issued for Planning
N1	03.06.25	Issued for Information
I/R	DATE	DESCRIPTION

**PROJECT NUMBER**  
300-101269

**SHEET TITLE**  
Site Layout Plan - Sheet 6 of 12

**SHEET NUMBER**  
300101269-DR-110

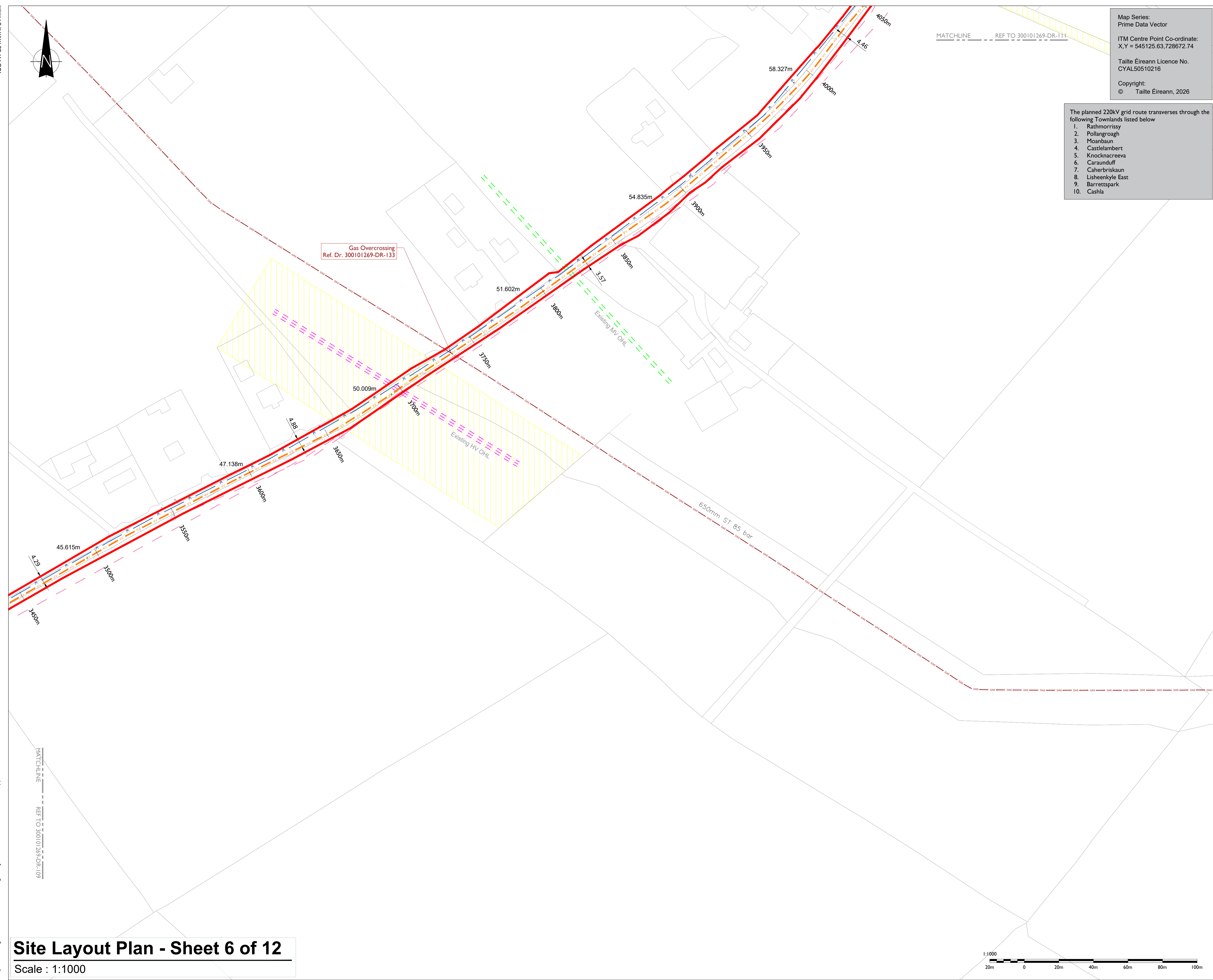

Project Management Initials: Designer: JC Checked: GC Approved: DB

MATCHLINE REF TO 300101269-DR-109

**Site Layout Plan - Sheet 6 of 12**  
Scale : 1:1000

